

This drawing is intended to be used as a GUIDE of the APPROXIMATE room setup at this facility. Whereas actual on-site variations or adjustments may occur, PSAV cannot be held responsible for submitting this as a final or exact plan.

DATE: 03/15/2011
SCALE: 1/8" = 1'-0"
DRAWN BY: MOORE
DRAWING NO.: PCC111BCR

ISTE 2011
LECTURE IVC/WRK SEMDEM
PENNSYLVANIA CONVENTION CENTER - PHILADELPHIA, PENNSYLVANIA
TOTAL SEATING: 45 (9-72" BANQUET ROUNDS; 5 PER TABLE)

ROOM: 111B
LAYOUT: CRESCENT ROUNDS
DIMENSION: 35'-9"X 59'-8"
CEILING HEIGHT: 13'-0"

PSAV
925 FREEPORT PARKWAY, SUITE 100
COPPELL, TEXAS 75019-4491

PSAV
PRESENTATION SERVICES

TEL.: 800-966-4498
FAX: 866-312-4478

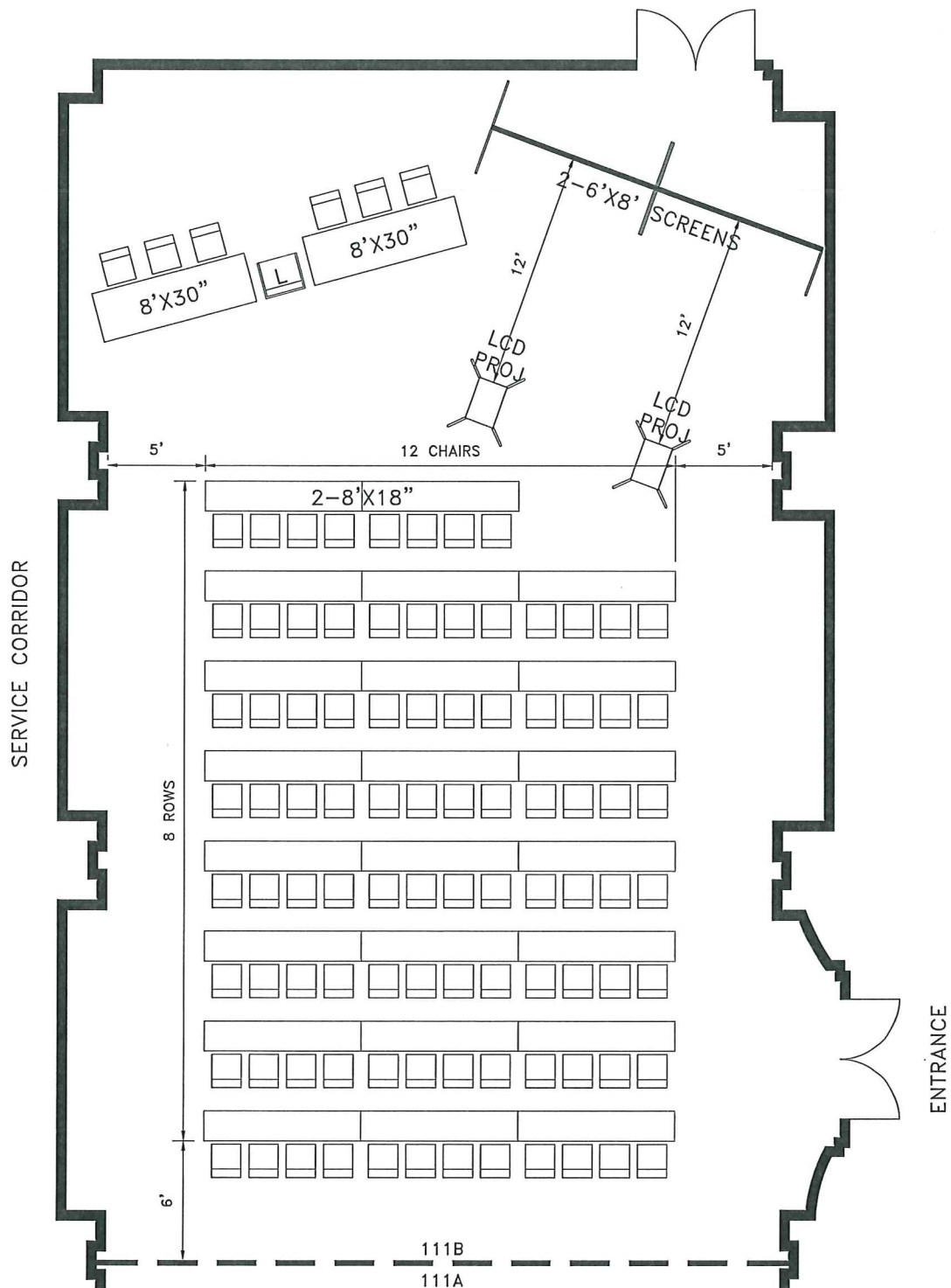

This drawing is intended to be used as a GUIDE of the APPROXIMATE room setup at this facility. Whereas actual on-site variations or adjustments may occur, PSAV cannot be held responsible for submitting this as a final or exact plan.

DATE: 03/15/2011
 SCALE: 1/8" = 1'-0"
 DRAWN BY: MOORE
 DRAWING NO.: PCC111BC

ISTE 2011
 LECTURE - IVC
 PENNSYLVANIA CONVENTION CENTER - PHILADELPHIA, PENNSYLVANIA
 TOTAL SEATING: 92

ROOM: 111B
 LAYOUT: CLASSROOM
 DIMENSION: 35'-9" X 59'-8"
 CEILING HEIGHT: 13'-0"

PSAV
 925 FREEPORT PARKWAY, SUITE 100
 COPPELL, TEXAS 75019-4491

PSAV
 PRESENTATION SERVICES

TEL.: 800-966-4498
 FAX: 866-312-4478

THIS DRAWING IS THE PROPERTY OF PSAV AND REPRODUCTION OR USE WITHOUT WRITTEN CONSENT IS PROHIBITED.